

Pool Ladders

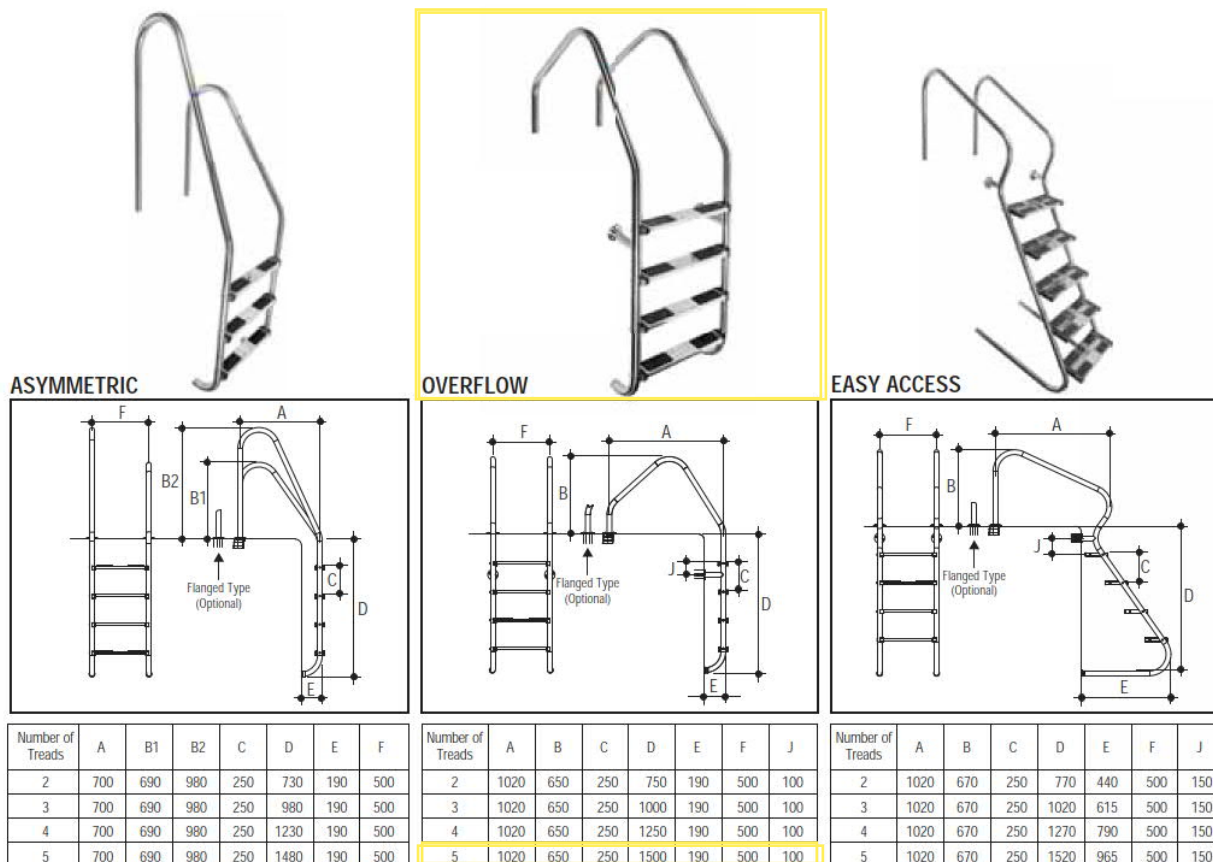

ASYMMETRIC 316 MODEL WITH STAINLESS STEEL TREADS.

500 mm width. Treads in AISI 316 quality stainless steel and anti-slip.

Handrails made of Ø 42 mm pipe are in AISI 316 quality polished stainless steel.

Manufactured with double safety tread in accordance to EN 13451-2/AC standard.

Complete with plastic anchors, anchor escutcheons, end caps, bolts and nuts.

Description	Code	Pieces/box	Weight Kg	Volume m ³
• With 2 Stainless Steel Treads	0312811	1		0,247
• With 3 Stainless Steel Treads	0312812	1		0,247
• With 4 Stainless Steel Treads	0312813	1		0,247
• With 5 Stainless Steel Treads	0312814	1		0,271

OVERFLOW 316 MODEL WITH STAINLESS STEEL TREADS.

Description	Code	Pieces/box	Weight Kg	Volume m ³
• With 2 Stainless Steel Treads	0312411	1	12,500	0,247
• With 3 Stainless Steel Treads	0312412	1	13,700	0,247
• With 4 Stainless Steel Treads	0312413	1	15,100	0,247
• With 5 Stainless Steel Treads	0312414	1	17,000	0,271

EASY ACCESS 316 MODEL WITH STAINLESS STEEL TREADS.

Description	Code	Pieces/box	Weight Kg	Volume m ³
• With 2 Stainless Steel Treads	0312511	1		
• With 3 Stainless Steel Treads	0312512	1		
• With 4 Stainless Steel Treads	0312513	1		
• With 5 Stainless Steel Treads	0312514	1		

GEMAS OVERFLOW MODEL LADDERS



TECHNICAL DATA SHEET

"Pool Technology"

OVERFLOW 304 and 316 MODEL WITH STAINLESS STEEL TREADS: 500 mm width. Treads in AISI 304 and 316 quality stainless steel and anti-slip. Handrails made of Ø 42 mm pipe are in AISI 304 and 316 quality polished stainless steel. Complete with plastic anchors, anchor escutcheons, end caps, bolts and nuts.

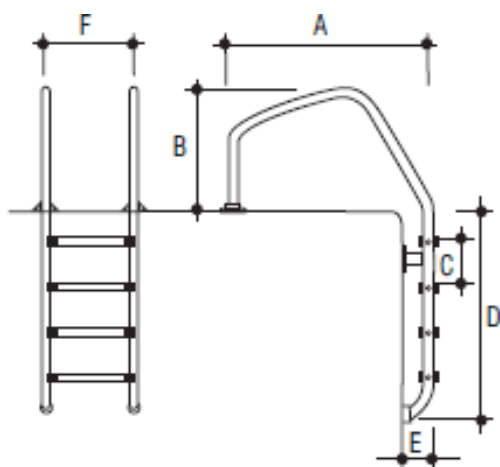

Number of Treads	A	B	C	D	E	F
2	1020	720	250	650	180	500
3	1020	720	250	900	180	500
4	1020	720	250	1150	180	500
5	1020	720	250	1400	180	500

MODEL NAME	MODEL CODE
OVERFLOW 304 MODEL WITH STAINLESS STEEL TREADS. With 2 Stainless Steel Treads	0311411
OVERFLOW 304 MODEL WITH STAINLESS STEEL TREADS. With 3 Stainless Steel Treads	0311412
OVERFLOW 304 MODEL WITH STAINLESS STEEL TREADS. With 4 Stainless Steel Treads	0311413
OVERFLOW 304 MODEL WITH STAINLESS STEEL TREADS. With 5 Stainless Steel Treads	0311414
OVERFLOW 316 MODEL WITH STAINLESS STEEL TREADS. With 2 Stainless Steel Treads	0312411
OVERFLOW 316 MODEL WITH STAINLESS STEEL TREADS. With 3 Stainless Steel Treads	0312412
OVERFLOW 316 MODEL WITH STAINLESS STEEL TREADS. With 4 Stainless Steel Treads	0312413
OVERFLOW 316 MODEL WITH STAINLESS STEEL TREADS. With 5 Stainless Steel Treads	0312414

Spare Parts

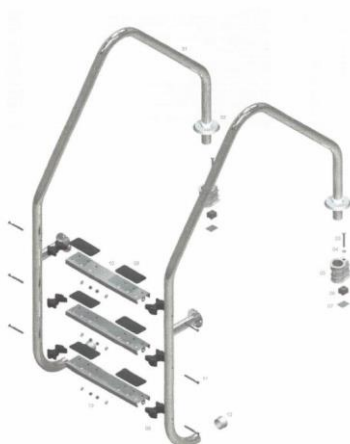

Part No	Code	Description	2 Ladder	3 Ladder	4 Ladder	5 Ladder
01		OVERFLOW, POOL LADDER ARM (AISI 304 or 316)	2	2	2	2
02	032022	ANCHOR ESCUTCHEON - PLASTIC	2	2	2	2
	032021	ANCHOR ESCUTCHEON - AISI 304	2	2	2	2
03	032011	M8X70 INOX SCREW	2	2	2	2
04	03202	WASHER INOX M8	6	8	10	12
05	032014	LADDER ANCHOR BODY	2	2	2	2
06	032013	LADDER ANCHOR BLOCK	2	2	2	2
07	032015	LADDER ANCHOR BOTTOM LID	2	2	2	2
08	0320313	INOX LADDER TREAD BODY SIDE PLUG	4	6	8	10
09	0320312	INOX LADDER TREAD PLASTIC PED	4	6	8	10
10	0320314	INOX LADDER TREAD BODY	2	3	4	5
11	03203	INOX TREAD SCREW SPECIAL HEAD M8X70	4	6	8	10
12	03204	PLASTIC END CAP	2	2	2	2
13	03205	INOX NUT M8	4	6	8	10

EC DECLARATION OF CONFORMITY (AT UYGUNLUK BEYANI)

**Manufacturer
(Üretici)**

**: GEMAŞ GENEL MÜH. MEKANİK SAN. VE
TİC. A.Ş.**
Mimar Sinan Mah. Yasemin Sok. No:16 Kemerburgaz
İSTANBUL-TÜRKİYE

**Product Description :
(Ürün Tanımı)**

POOL LADDERS, HANDRAILS

**Applied Standarts
(Uygulanan Standart)**

**: EN ISO 16582-1 (Domestic swimming pools - Part 1:
General requirements including safety and test
methods)
EN ISO 16582-2 (Domestic swimming pools - Part 2:
Specific requirements including safety and test
methods for inground pools)
EN ISO 16582-3 (Domestic swimming pools - Part 3:
Specific requirements including safety and test
methods for aboveground pools)**

**Date of Marking
(Markalama Tarihi)**

: 16.06.2019

**Valid Until
(Geçerlilik Tarihi)**

: 16.06.2021

**Declaration No
(Beyan Numarası)**

: GEMAS/ 2019-001-P.01-16.06.2019

We hereby declare that above mentioned products are in compliance with European Directive For Pool Accesories.

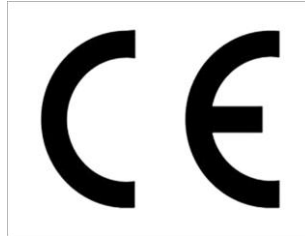

Mehmet Demir
Quality Engineer

İstanbul/TÜRKİYE
June , 2019

