

Hang-over Filtration Units

GEMAS "DECKON JET" HANG-OVER FILTRATION UNIT with COUNTER CURRENT.

Hang-over Unit: Body made of UV resistant ABS plastic; complete with 23 W/12 V LED underwater light, skimmer, suction inlet, 2+1 side and bottom oriented inlets, jet inlet, air regulator, counter current on/off pneumatic button, stainless steel handles. Separated assembly of hang-over unit and filter room is possible by using two different plastic covers (included).

Filtration Room: Base part made in FRP, upper frame + room cover made in UV resistant ABS plastic. Complete with circulation pump, 2 HP jet pump, cartridge or cartridge sand filter, electrical control board, pneumatic on/off switch and transformers. Machine room and Hang-over unit can be installed separately. Top covers for such application is included.



Description	Code	Pieces/box	Weight Kg	Volume m ³
Hang-over Unit	02511J	1	20,000	0,420
Filtration Room w/Sand Filter				
• Ø 400 mm Sand Filter + 1/2" HP + 2" HP Jet Pump - 6 m ³ /h	02512J	1	85,850	0,870
• Ø 500 mm Sand Filter + 3/4" HP + 2" HP Jet Pump - 10 m ³ /h	02513J	1	89,650	0,870

PS. In case of any inquiry for Ø 615 or Ø 710 filter, this unit could be incorporated w/filtration room 02517.

Filtration Room w/Cartridge Filter

• P510 Cartridge Filter + 1/2" HP + 2" HP Jet Pump - 6 m ³ /h	02514J	1		
• P512 Cartridge Filter + 3/4" HP + 2" HP Jet Pump - 10 m ³ /h	02515J	1		
• P513 Cartridge Filter + 1" HP + 2" HP Jet Pump - 15 m ³ /h	02516J	1		

Options

• ECOSlimLED Light	051130EO	1		
• Chlorine Feeder	069CLT167B	1		

PS. Filter media not included.

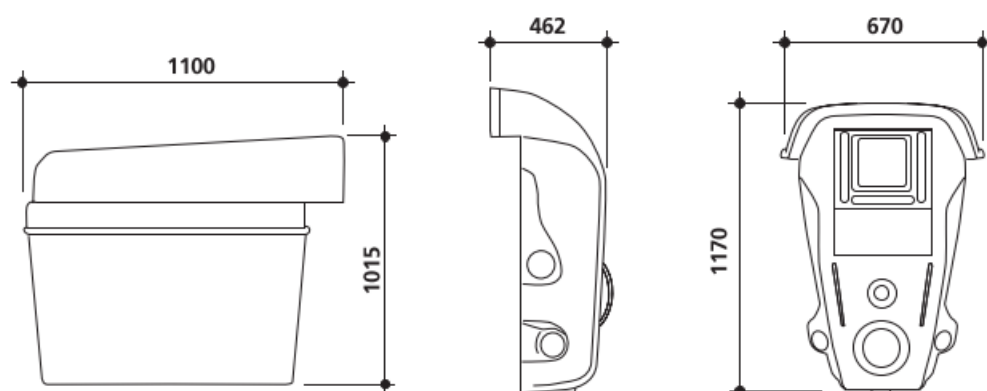

"Premium" High Rate Sand Filters

GEMAS "PREMIUM" PE PLASTIC SAND FILTERS.

Filter shell made of PE Plastic by Rotational Moulding.
One-piece body, including pressure gauge, side or top mounted
multiport valve and air purge. Two years body warranty.
Test pressure 3,5 kg/cm². Max. operation pressure 2,5 kg/cm².
Filtration rate: 50 m³/h/m².



Ergonomic Clamped Lid



Side Multiport Valve and
Water Drainage



Folding Collector Arms

Description	Code	Pieces/ box	Weight Kg	Volume m ³
Top Mounted (clamped) Multiport Valve				
• Ø 400 mm - 6,30 m ³ /h	021921	1	9,000	0,140
• Ø 500 mm - 10,00 m ³ /h	021922	1	12,000	0,200
• Ø 615 mm - 15,00 m ³ /h	021923	1	16,000	0,325
Side Mounted Multiport Valve Including clamped lid & side connections				
• Ø 400 mm - 6,30 m ³ /h	021911	1	8,700	0,140
• Ø 500 mm - 10,00 m ³ /h	021912	1	11,700	0,200
• Ø 615 mm - 15,00 m ³ /h	021913	1	15,700	0,325

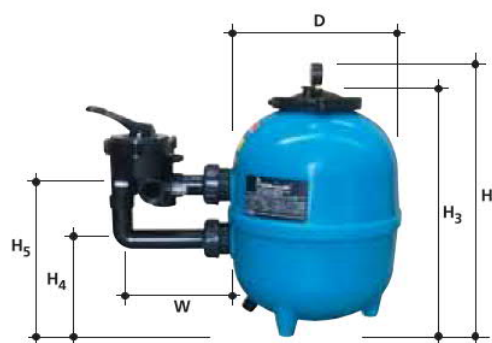

TECHNICAL CHARACTERISTICS

	Top Mounted Multiport Valve			Side Mounted Multiport Valve		
MODEL	021921	021922	021923	021911	021912	021913
D (mm)	400	500	615	400	500	615
H ₁ (mm)	695	735	855	615	660	775
H ₂ (mm)	525	565	685	-	-	-
H ₃ (mm)	-	-	-	555	600	715
H ₄ (mm)	-	-	-	200	220	280
H ₅ (mm)	-	-	-	330	350	410
W (mm)	-	-	-	260	260	260
W1 (mm)	-	-	-	-	-	-
CONNECTIONS Ø (mm)	1 1/2"	1 1/2"	1 1/2"	1 1/2"	1 1/2"	1 1/2"
FLOW (m ³ /h) (50 m ³ /h/m ²)	6,3	10	15	6,3	10	15
SAND (Kg)	80	100	150	80	100	150
NET WEIGHT (Kg)	9,000	12,000	16,000	8,700	11,700	15,700



GEMAS PREMIUM PE PLASTIC SAND FILTERS TECHNICAL DATA SHEET



Introduction:

Filter shell made of PE Plastic by Rotational Moulding. One-piece body, including pressure gauge, side or top mounted multiport valve and air purge. Test pressure 3,5 kg/cm². Max. operation pressure 2,5 kg/cm². Filtration rate: 50 m³/h/m².

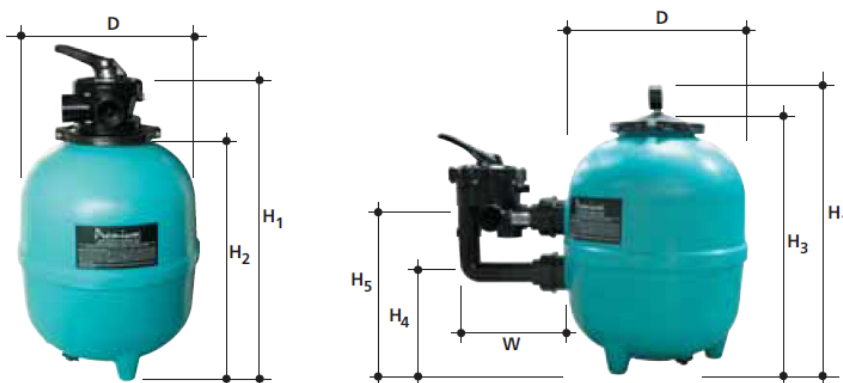

TECHNICAL CHARACTERISTICS

	Top Mounted Multiport Valve			Side Mounted Multiport Valve		
MODEL	400	500	615	400	500	615
D (mm)	400	500	615	400	500	615
H ₁ (mm)	760	800	920	615	660	775
H ₂ (mm)	525	565	685	-	-	-
H ₃ (mm)	-	-	-	555	600	715
H ₄ (mm)	-	-	-	200	225	280
H ₅ (mm)	-	-	-	325	350	410
W (mm)	-	-	-	260	260	260
W1 (mm)	-	-	-	-	-	-
CONNECTIONS (Ø)	1 1/2"	1 1/2"	1 1/2"	1 1/2"	1 1/2"	1 1/2"
FLOW (m ³ /h) (50 m ³ /h/m ²)	6,3	10	15	6,3	10	15
SAND (Kg)	80	100	150	80	100	150
NET WEIGHT (Kg)	9,000	12,000	16,000	8,700	11,700	15,700

We reserve our right to change all or part of the features of the articles or contents of this document, without prior notice.



"Pool Technology"

Side Mounted Part List:

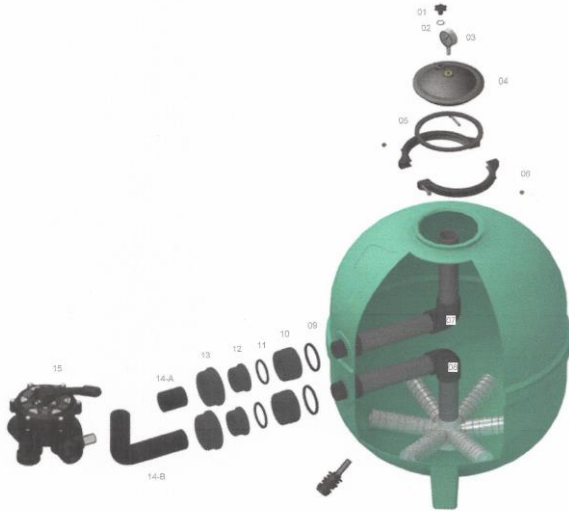

No	Filter Part Description	Qty
01	Air Purge	1
02	Air Purge O-ring	1
03	Manometer	1
04	Linked Clamps Filter Cover (Transparent opt.)	1
05	Gasket for Filter Lid with Clamp Connection	1
06	Clamp Set	1
07	Filter Inside Top Set	1
08	Filter Inside Bottom Set	1
09	Filter Connection Outer O-ring	2
10	Filter Connection Body	2
11	Filter Connection Inner O-ring	2
12	Pipe Connection	2
13	Filter Pipe Connection Nut	2
14-A	L Shaped Elbow	1
14-B	L Shaped Elbow Pipe Part	1
15	Multiport Valve	1
16	Water Drainage Set	1

Top Mounted Part List:



No	Filter Part Descriptions	Qty
01	Filter Manometer	1
02	Multiport Valve	1
03	Clamp Set	1
04	Filter Inside Set	
05	Gasket for Filter Lid with Clamp Connection	
06	Water Drainage	

Water Drainage Part List:



No	Water Drainage Part Description	Qty.
01	Water Drainage Nozzle	1
02	Water Drainage Nozzle Gasket	2
03	Water Drainage Nut	1
04	Water Drainage Purge Nut Gasket	1
05	Water Drainage Cap	1

Inside Bottom Set Part List:



No	Inside Bottom Set Part Descriptions
01	PVC PN10 Pipe
02	PVC Elbow
03	Male Threaded Adaptor
04	Filter Collector With 6/8/12 Outlets
05	Filter Collector Lid
06	Filter Candle – No:1 Inner Part
07	Filter Candle – No:2 Inner Part
08	Filter Candle – Outer Part
09	Filter Candle – Blind Cap

Note: Part quantities and diameters depend on filter model.

EC DECLARATION OF CONFORMITY (AT UYGUNLUK BEYANI)

Manufacturer (Üretici) : GEMAŞ GENEL MÜH. MEKANİK SAN. VE TİC. A.Ş.
Mimar Sinan Mah. Yasemin Sok. No:16 Kemerburgaz
İstanbul – Türkiye

Product Description (Ürün Tanımı) : Sand Filters
(Kum Filtresi)

Applied Standard (Uygulanan Standart) : 2014/68/EU (Regulation on Pressure Equipment)
2014/68/AT (Basıncılı Ekipmanlar Yönetmeliği – Turkish Standart)

Model Name : Turbidron, Filtrex, Filtrone, Neptune, Premium, Filtegra, Ikarus

Date of CE Marking (CE Markalama Tarihi) : 19.05.2022

Valid Until (Geçerlilik Süresi) : 19.05.2024

Decleration No (Beyan Numarası) : GEMAS/2014-004-F.00-20.05.2024

We hereby declare that above mentioned products are in compliance with Regulation on Pressure Equipment 2014/68/EU (2014/68/AT)



Mehmet Demir
Quality Engineer

İstanbul / Türkiye
May, 2022

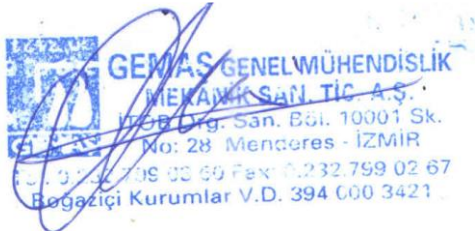

İstanbul Merkez:
Mimar Sinan Mah. Yasemin Sk.
No:16 34075,
Kemerburgaz - Eyüp / İSTANBUL
T : (0212) 321 92 30 pbx
F : (0212) 294 77 35
@ : info@gemas.com.tr

İzmir Fabrika:
İTOB Organize Sanayi Bölgesi
10001 Sk. No:28 35477,
Tekeli-Menderes / İZMİR
T : (0232) 799 03 60 (6 Hat)
F : (0232) 799 02 67
@ : info@gemas.com.tr

İstanbul Ana Depo:
Cendere Yolu,
Çakırlar Sk. No:19 34396,
Ayazağa-Şişli / İSTANBUL
T : (0212) 360 06 93-321 93 32
F : (0212) 321 95 83
@ : info@gemas.com.tr

Antalya Şube:
Arapsuyu Mah. 7. Cad.
Damla Apt. No:33/1-2
0770, ANTALYA
T : (0242) 229 66 91 - 92
F : (0242) 229 66 93
@ : info@gemas.com.tr

İzmir Şube:
1443 Sk. No:2/S
Tesisat İş Merkezi
35110, Yenisehir / İZMİR
T : (0232) 449 19 26
F : (0232) 449 19 29
@ : bilgi@rxmediapharma.com

Self-priming Pool Pumps

2850 rpm

GEMAS "STREAMER MINI"

Self-priming, thermoplastic body Monoblock Pool Pump;
complete with pre-filter. Pump shaft in stainless steel.
Suction & Discharge 1 1/2". 2850 rpm - IP 55 Motor.
Connections are with unions compatible with
Fitvalf d50 Ball Valve. Easy opening lid with 40° rotation.
"Xylex" lid option against aggressive chemicals.



Easy access lid



Self Coupling



Coupling compatible with d50 Fitvalf ball valve handle



Noryl impeller



Stainless steel motor shaft

Description	Code	Pieces/box	Weight Kg	Volume m ³
• STRM-33M 1/3 HP, Monophase	0111STRM33M	1	10,980	0,037
• STRM-50M 1/2 HP, Monophase	0111STRM50M	1	11,140	0,037
• STRM-80M 3/4 HP, Monophase	0111STRM80M	1	13,200	0,037
• STRM-80T 3/4 HP, Triphase	0111STRM80T	1	13,000	0,037
• STRM-100M 1 HP, Monophase	0111STRM100M	1	12,800	0,037
• STRM-100T 1 HP, Triphase	0111STRM100T	1	11,620	0,037
• STRM-150M 1,5 HP, Monophase	0111STRM150M	1	12,800	0,037
• STRM-150T 1,5 HP, Triphase	0111STRM150T	1	11,620	0,037

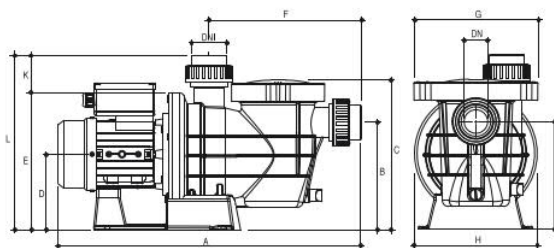
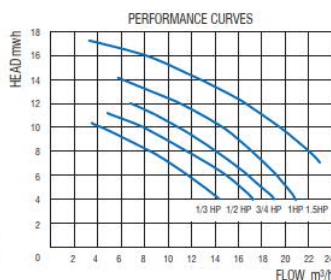

PUMP TYPE	HP	CON- DEN- SER (μF)	AMPERES			HEAD mwh									
						II 220 V	III 220 V	380 V	4	6	8	10	11	12	14
			FLOW m³/h												
STRM-0.33M	0.33	12.50	2.70	-	-	14.10	11.60	8.30	4.00	-	-	-	-	-	
STRM-0.50M	0.50	14.00	2.60	-	-	17.20	14.90	11.40	7.90	4.80	-	-	-	-	
STRM-0.80T/M	0.75	14.00	3.50	2.50	1.45	18.90	16.70	13.50	10.80	9.00	6.80	-	-	-	
STRM-1.00T/M	1.00	14.00	3.50	2.50	1.45	20.80	19.30	17.10	14.90	13.20	10.50	6.00	-	-	
STRM-1.50T/M	1.50	20.00	4.60	3.30	1.90	26.00	24.80	22.00	19.50	18.00	16.50	12.50	15.00	-	

PUMP TYPE	DIMENSIONS												Net Weight (Kg)		Gross Weight (Kg)	
	DNA	DNI	A	K	B	C	D	E	F	G	H	L	Mo.	Tri.	Mo.	Tri.
STRM-0,33M	11/2"	11/2"	510	70	175	265	140	240	255	210	210	315	9,980	-	10,980	-
STRM-0,50M	11/2"	11/2"	540	70	175	265	140	240	255	210	210	315	10,140	-	11,140	-
STRM-0,80T/M	11/2"	11/2"	540	70	175	265	140	240	255	210	210	315	12,200	-	13,200	13,000
STRM-1,00T/M	11/2"	11/2"	540	70	175	265	140	240	255	210	210	315	11,800	10,620	12,800	11,620
STRM-1,50T/M	11/2"	11/2"	540	70	175	265	140	240	255	210	210	315	11,800	10,620	12,800	11,620

SUCTION PIPE DIMENSIONS

PUMP TYPE	STRM-33M	STRM-50M	STRM-80T/M	STRM-100T/M	STRM-150T/M
Ø SUCTION PIPE	1 1/2" (Ø50 mm)	1 1/2" (Ø50 mm)	2" (Ø63 mm)	2" (Ø63 mm)	2 1/2" (Ø75 mm)

PS: It is recommended to use conical reduction at the suction line of the pump.



Please read carefully the instruction manual before starting the installation process. The installation should be in accordance to the local standards.

1. APPLICATIONS

The swimming pool pump model STREAMER Mini has a horizontal centrifugal construction. Its main application is to circulate the swimming pool pump water and normally it is installed before the filtration equipment. The pump is designed to move about incoming and the outgoing water from the chlorine disinfected swimming pool. The STREAMER MINI pumps have a removable basket for filtering of small solids.

2. TECHNICAL INFORMATION

2.1 Maximum environment temperature: +50°C.

2.2 Water Temperature: From 0°C to 50°C

2.3 Maximum working pressure permitted: 2 Bar.

2.4 Maximum inlet pressure: When the pump Works with a closed valve the inlet pressure should be lower than the maximum working pressure permitted always.

2.5 Minimum suction head:

TYPE	Maximum Suction with Check Valve	Maximum Autosuction
STREAMER MINI	5 m	4 m

2.6 Self Priming: The STREAMER MINI pumps are self priming up to 4m height.

2.7 Electrical Details:

TYPE	Voltage
STREAMER MINI-33M STREAMER MINI-50M STREAMER MINI-80M STREAMER MINI-100M	1 x 230 V 50 Hz
STREAMER MINI-80T STREAMER MINI-100T STREAMER MINI-150T	3 x 230 / 400 V 50 Hz

See also the characteristics plate.

Water proof type: IP55

Isolation Class: F

2.8 Dimensions: See the drawing on the final of this manual

2.9 Sound level: The sound pressure level of the pump is lower than 70db.

2.10 Weights:

Streamer Mini Series	Weight (kg)
STREAMER MINI-33M	8,750
STREAMER MINI-50M	9,150
STREAMER MINI-80M	11,050
STREAMER MINI-80T	11,350
STREAMER MINI-100M	12,050
STREAMER MINI-100T	11,450
STREAMER MINI-150M	12,150
STREAMER MINI-150T	11,550

3. INSTALLATION

Normally the STREAMER MINI swimming pool pumps are installed between the skimmer/balance tank and the swimming pool filter.

The pump should be placed on a flat, solid foundation with the shaft in horizontal position and the prefilter cover uppermost.

It must be possible to remove the transparent cover so that the prefilter basket can be removed for cleaning.

The suction pipe must have as minimum the same diameter as the pump suction line with continuous slope in order to avoid long priming times. If the suction line exceeds 10 meters, the extra pressure loss should be considered.

The pipes should be installed to avoid any air leaks in its interior. The following drawing shows a correctly fitted piping.

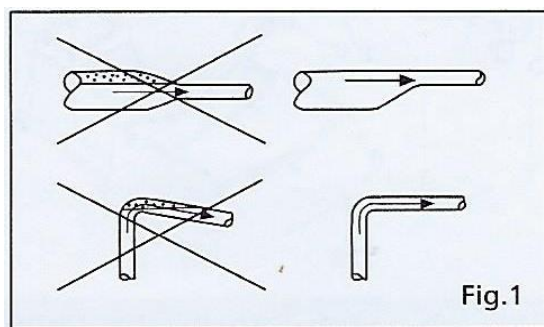

The pipes should be fitted in such a way that any pressure variation caused by temperature changes do not effect the pump. If the piping is very long and/or high support the pump in front and behind. It is recommended to put a retention or check valve at the outlet.



The plastic pipes and connections should be screwed carefully.

In case of using a suction hose, it must be non-compressible (with a reinforcement spiral).

The suction pipe/hose should be the shortest possible in order to assure optimum working conditions.

It's recommendable to install shutting valves the both sides in order to isolate the pump.

Note: The pump does not allow to work with closed discharge valve as it may cause an increase of the temperature and steam formation which can damage the pump. If there is any possibility of operating the pump with discharge valve closed, it's necessary to connect one bypass/mud valve on the discharge pipe in order to assure a minimum liquid flow through the pump.

Streamer Mini Series	Suction Pipe Size
STREAMER MINI-33M	1 1/2" (Ø50 mm)
STREAMER MINI-50M	1 1/2" (Ø50 mm)
STREAMER MINI-80M/T	2" (Ø63 mm)
STREAMER MINI-100M/T	2" (Ø63 mm)
STREAMER MINI-150M/T	2 1/2" (Ø75 mm)

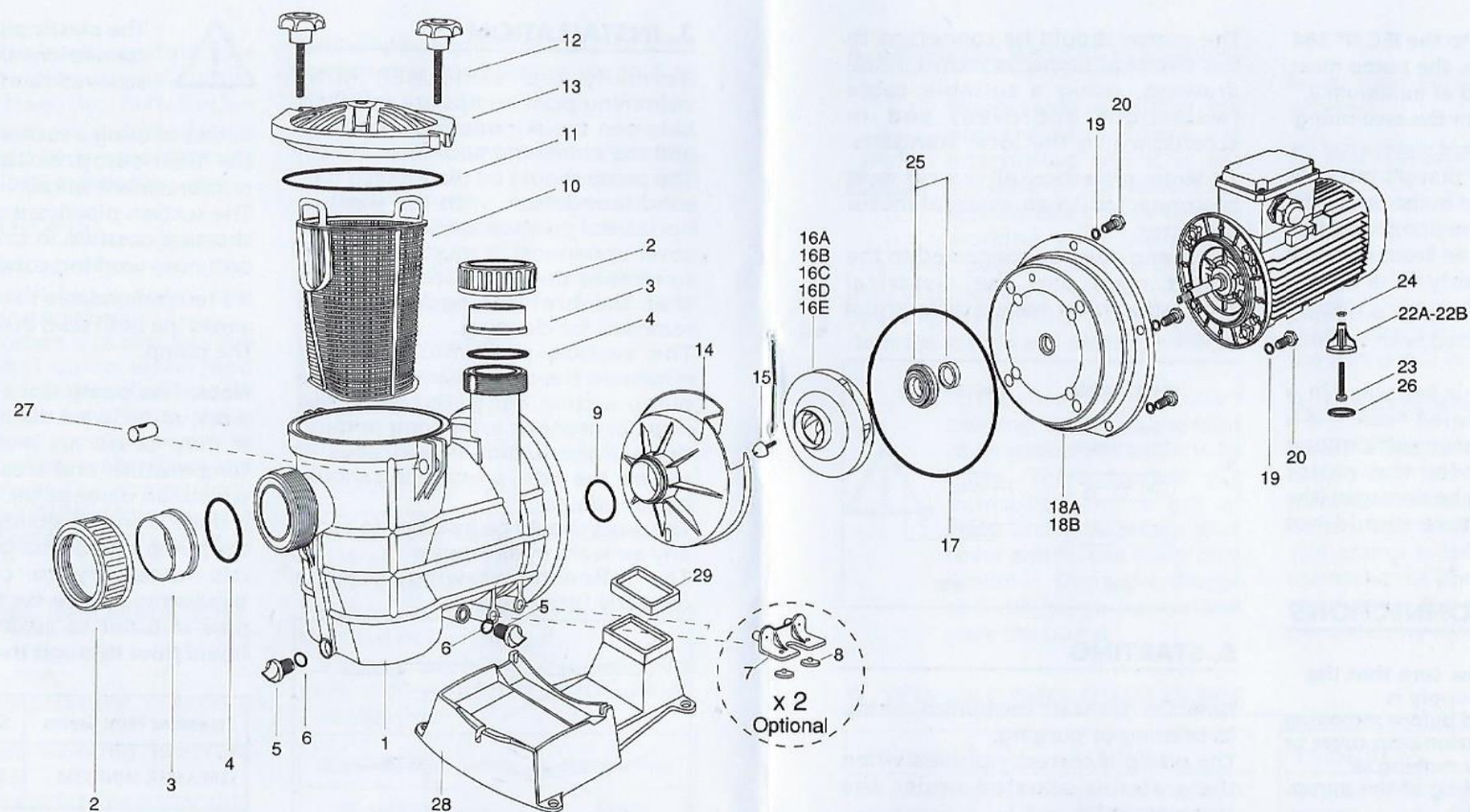

NO	CODE	DESCRIPTION	NO	CODE	DESCRIPTION	NO	CODE	DESCRIPTION
1	0111STRM01	Streamer pump body	12	0111STR09	Prefilter lid bolt	18B	0111STRM13	Mini Streamer rear pump body (63 body)
2	13111412A	Mini pump connection nut 1 1/2"	13	0111STRM06	Mini Streamer prefilter lid	19	03202	Washer inox M8
3	0111STRM02	Mini pump pipe connection 1 1/2"	14	0111STRM07	Diffuser for mini pump	20	0111STR21	Inox screw M8x20
4	0111STRM03	Gasket for mini pump union	15	0111STR37	Inox counter screw M6x20	22A	0111STR30	Pump leg (80 body), Mini Streamer (71 body)
5	0111STR02	Drain plug	16A	0111STRM08	Mini Streamer impeller 1/3 HP	22B	0111STR30A	Mini Streamer pump leg (63 body)
6	0111STR03	O-ring for drain plug	16B	0111STRM09	Mini Streamer impeller 1/2 HP	23	0111STRM17	Inox screw, for motor leg M5x40 (Mini STR.)
7	0111STR04	Pump leg	16C	0111STRM10	Mini Streamer impeller 3/4 HP	24	0111STR33	Inox nut, for motor leg M5
8	0111STR05	Antivibrator pad for pump leg	16D	0111STRM11	Mini Streamer impeller 1 HP	25	0111STR34	Mechanical seal complete
9	0111STR06	Diffuser gasket	16E	0111STRM14	Mini Streamer impeller 1,5 HP	26	0111STR35	Antivibrator pad for motor leg
10	0111STRM04	Mini Streamer prefilter basket	17	0111STRM12	Mini Streamer pump body o-ring	27	0111STR36	Housing for filter lid bolts
11	0111STRM05	Mini Streamer prefilter lid gasket	18A	0111STRM13A	Mini Streamer rear pump body (71 body)	28	0111STRM04H	High pump leg (Mini Streamer) (New optional base)
						29	0111STRM04H1	High pump leg chock (Mini Streamer) (New optional base chock)



According to IEC N°364 publication, the pump must be installed at minimum 2 meters from the swimming pool edge.

3.1 Ventilation: The pump's motor is cooled by fan, placed in the back side. You should install the pump in a well ventilated place (free from possible freezing), preferably in a room.

a) If the pump is installed outdoors, it must be protected with suitable cover.

b) If the pump is installed in a buried or semiburied "case", it is necessary to assure a sufficient air entrance in order the motor ventilation not to be damaged (the inside temperature should not exceed the 50°C).

4. ELECTRICAL CONNECTIONS



Please make sure that the electrical supply is interrupted before removing the connection case cover or before any moving or disassembling of the pump.

Electrical connections must be done by a Professional and according to the local standards.

The pump must be connected to an external switch.

The voltage and frequency are marked on the characteristics plate. Please make sure that the motor is suitable to electrical supply in the network.

The motor should be connected to the electrical supply as shown in the drawing, using a suitable cable (watertight approved) and in accordance to the local standards.

4.1 Motor Protection: All version must be connected to an external motor protector.

The pump must be connected to the outlet mass and electrical installation must have a differential circuit.

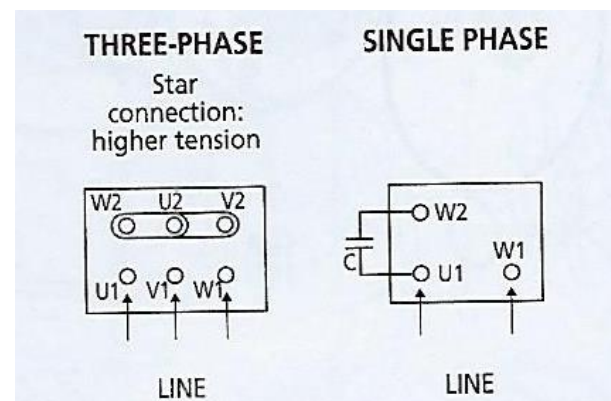

5. STARTING

Note: Do not start the pumps during its priming or purging.

The pump is correctly primed when the water is situated under the transparent lid.

The arrows on the pump housing indicate the correct rotation.

In order to create a maximum suction capacity during the starting, close the discharge valve, start the pump and open slowly the discharge valve. If the pump does not work correctly 5 minutes later, stop the pump check the water level in both the suction pipe and in the pump prefilter.

6. PREFILTER BASKET CLEANING



Please make sure that the electrical supply is interrupted and it is not possible to be connected accidentally before to start working with the pump.

The filter basket must be checked daily and cleaned if necessary. **Before opening the prefilter cover, please close the suction and discharge valves.**



After the filter basket cleaning, clean also the filter cover gasket and put it in its place. Then check if the pump housing is full of water and if so, put the filter cover and fix the cover nuts similarly. Open the charge and discharge valves and start the pump.

Note: High pressure cleaning is not allowed.

7. WINTERIZING

If the Pump will not be used during the winter, remove all plugs and drain the pump and all piping. To drain the pump, please take off the drain plugs (5) from the pump housing. Do not put the drainage plugs up till the pump will be used again.

8. MAINTENANCE

Please make sure that the electrical supply is interrupted and it is not possible to be accidentally connected before the pump to start working. The pump is designed to operate maintenance under normal working conditions. The motor bearings are permanently lubricated.

9. TROUBLE SHOOTING

TROUBLE	CAUSE
The pump works, but does not prime.	<ol style="list-style-type: none">1. No water in the strainer pot.2. Pump not purged.3. Filtration in the piping / suction hose.4. Incorrect closing of the transparent lid.<ul style="list-style-type: none">- Check the prefilter basket- Tight well the lid screws5. Too high suction head<ul style="list-style-type: none">- Maximum suction head permitted is 3 meters.6. The suction line sucks air through connections.7. Mechanical seal leaking.

TROUBLE	CAUSE
The pump does not work satisfactory.	<ol style="list-style-type: none">1. Incorrect direction of rotating (only in case of 3-phase pumps)<ul style="list-style-type: none">- Change the rotating direction2. The prefilter basket or the skimmer are dirty or blocked.<ul style="list-style-type: none">- Clean the prefilter basket3. The water level in the swimming pool is too low.<ul style="list-style-type: none">- Increase the water level up to the 1/2 of the pool capacity4. The piping / hose is partially blocked by impurities<ul style="list-style-type: none">- Clean the piping / suction hose.

STREAMER MINI DIMENSIONS DRAWING

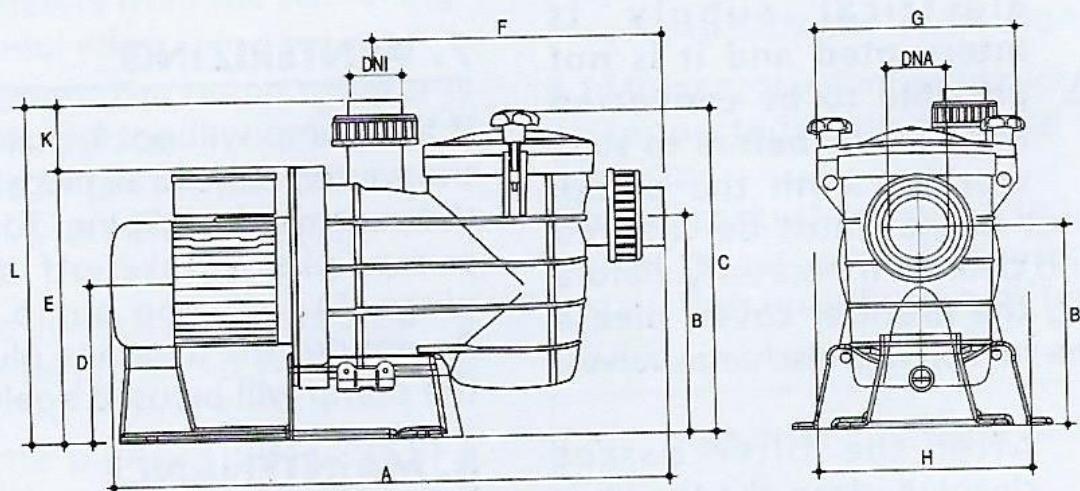

TYPE	DIMENSIONS (mm)											
	DNA	DNI	A	K	B	C	D	E	F	G	H	L
STRM - 0,33M	1 1/2"	1 1/2"	500	70	175	280	125	230	255	205	175	300
STRM - 0,50M	1 1/2"	1 1/2"	500	70	175	280	125	230	255	205	175	300
STRM - 0,80T/M	1 1/2"	1 1/2"	500	70	175	280	125	230	255	205	175	300
STRM - 1,00T/M	1 1/2"	1 1/2"	500	70	175	280	125	230	255	205	175	300
STRM - 1,50T/M	1 1/2"	1 1/2"	500	70	175	280	125	230	255	205	175	300

mini Streamer®

Self - Priming Centrifugal Pump for Pools



Quality Management System

" MINI STREAMER " SELF-PRIMING CENTRIFUGAL PUMP FOR POOLS



The Mini Streamer Pumps are precision, injection - moulded units, using a temperature and corrosion resistant fiber glass low dense plastic. The difference between Mini Streamer and other pumps lies in their uncomparable performance.

- Equipped with an IP55 totally enclosed motor, designed for continuous running. Particularly silent and resistant to moisture. Elevated support with antivibration pad facilitates extra protection against flood and vibration.
- The excellent design of the rotating elements and pump chamber ensures maximum water flow without turbulence which is the reason of exceptionally good performance curves.
- Rustproof ceramic and high duty carbon mechanical seal has a heat sink which allows cooler running, longer life and loss wear.
- Motor and pump are separated in such a way that any contact between the electrical components and pumped water is virtually impossible.
- Unions at both inlet and outlet facilitates easy removal of the pump from the system for service purposes. Unions are compatible with Fitvalf d50 ballvalve handle.
- Brand new easy opening design lid.

Characteristics

Monoblock pump body, in 30% fiberglass polypropylene for protection against corrosive water. Housed inside is a PREFILTERING BASKET that has a large filtering surface. High quality stainless steel shaft and mechanical seal. Noryl ultrasound soldered impeller.

Motor

IP55 protected. 230V or 230/400V - 50Hz. Noise level below 62db. 2850 rpm.

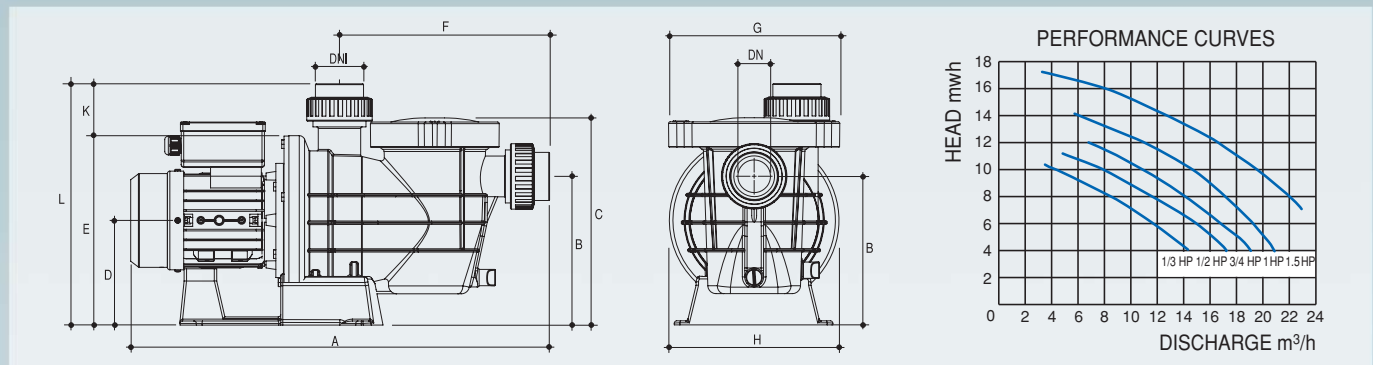

PUMP TYPE	HP	CON-DAN-SATOR (µF)	AMPERES			HEAD mwh								
			II 230 V	III		4	6	8	10	11	12	14	16	17
				230 V	400 V	DISCHARGE m³/h								
STRM-0,33M	0,33	16	2,50	-	-	14,10	11,60	8,30	4,00	-	-	-	-	-
STRM-0,50M	0,50	20	2,70	2,33	-	17,20	14,90	11,40	7,90	4,80	-	-	-	-
STRM-0,80T/M	0,75	25	3,40	3,03	1,44	18,90	16,70	13,50	10,80	9,00	6,80	-	-	-
STRM-1,00T/M	1,00	30	3,60	4,42	1,48	20,80	19,30	17,10	14,90	13,20	10,50	6,00	-	-
STRM-1,50T/M	1,50	30	5,15	4,60	2,30	26,00	24,80	22,00	19,50	18,00	16,50	12,50	15,00	-

PUMP TYPE	DIMENSIONS (mm)												Net Weight (Kg)		Packing W. (Kg)	
	DNA	DNI	A	K	B	C	D	E	F	G	H	L	Mo.	Tri.	Mo.	Tri.
STRM-0,33M	1 1/2"	1 1/2"	500	70	175	270	125	230	255	210	175	300	8,750	-	7,750	-
STRM-0,50M	1 1/2"	1 1/2"	500	70	175	270	125	230	255	210	175	300	9,150	-	8,150	-
STRM-0,80T/M	1 1/2"	1 1/2"	500	70	175	270	125	230	255	210	175	300	11,050	11,350	10,050	10,350
STRM-1,00T/M	1 1/2"	1 1/2"	500	70	175	270	125	230	255	210	175	300	12,050	11,450	11,050	10,450
STRM-1,50T/M	1 1/2"	1 1/2"	500	70	175	270	125	230	255	210	175	300	12,150	11,550	11,150	10,550

PUMP TYPE	STRM-33M	STRM-50M	STRM-80T/M	STRM-100T/M	STRM-150T/M
Ø SUCTION PIPE	1 1/2" (Ø50 mm)	1 1/2" (Ø50 mm)	2" (Ø63 mm)	2" (Ø63 mm)	2 1/2" (Ø75 mm)

PUMP TYPE	PACKING DIM. (mm)
STRM-33/50/80/100/150	540 x 210 x 370

PS: It is recommended to use conical reduction at the suction line of the pump

We reserve the right to change all or part of the features of the articles or contents of this document, without prior notice.



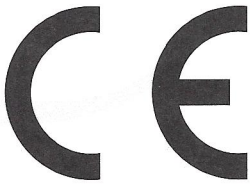

UYGUNLUK ONAYI ATTESTATION OF COMPLIANCE

Reference No:
Referans Nu.:

TRC-21-1510/01

Applicant:
Başvuru Sahibi:

Gemaş Genel Mühendislik Mekanik San. ve Tic. A.Ş
İTOB Organize Sanayi Bölgesi 10001 Sokak No: 28 Tekeli Menderes
İzmir / Türkiye

Manufacturer:
Üretici:

Gemaş Genel Mühendislik Mekanik San. ve Tic. A.Ş
İTOB Organize Sanayi Bölgesi 10001 Sokak No: 28 Tekeli Menderes
İzmir / Türkiye

Product:
Ürün:

STREAMER MONOPHASE POOL PUMP
STREAMER MONOFAZE HAVUZ POMPASI

Type/Model:
Tip/Model

STRN-50M, STRN-80M, STRN-100M, STRN-150M, STRN-200M, TRN 300M, STRN-350M, STRM-33M, STRM-50M, STRM-80M, STRM-100 M, STRM-150M

Reference Directive(s):
Referans Yönetmelik(ler)

2006/42/EC Machinery Safety Directive
2014/35/EU The Laws Of The Member States Relating To The Making Available On The Market Of Electrical Equipment Designed For Use Within Certain Voltage Limits Directive
2014/30/EU On The Harmonisation Of The Laws Of The Member States Relating To Electromagnetic Compatibility
Makina Emniyeti Yönetmeliği (2006/42/AT)
Belirli Gerilim Sınırları İçin Tasarlanan Elektrikli Ekipman ile İlgili Yönetmelik (2014/35/AB)

Reference Standard(s):
Referans Standart(lar)

Elektromanyetik Uyumluluk Yönetmeliği (2014/30/AB)
TS EN 60204-1:2018, EN 60335-1:2012 + A11:2014 /AC:2014+A13:2017 +A14:2019 +A2:2019 +A1:2019, EN 60335-2-41:2003 + A1:2004 + A2:2010, TS EN ISO 12100:2010, EN 809:1998 +A1:2009/AC:2010, EN 61000-6-3:2007/A1:2011/AC:2012, EN 62233:2008

Base of attestation:
Onay Dayanağı:

File of technical documentation, test reports Ref. No. ECP.18.03.R0014, ECP.18.03.R0018, 18-1284-R00-N01-01, 20180115-001
Teknik Dökümantasyon, ECP.18.03.R0014, ECP.18.03.R0018, 18-1284-R00-N01-01, 20180115-001 numaralı test raporları

Issue Date:
Yayın Tarihi

15.10.2021

Expiry Date:

Geçerlilik Tarihi

14.10.2022

Integra96, has inspected the documentation presented concerning the product of the company whose name and address mentioned above according to the reference directive and/or reference standards. Suitability of product and documentation to the directive and standards are under the responsibility of the company. However, in case the product is subject to more than directives and standards which are mentioned above, when the company fulfills conditions of other directives and standards, then it can attach CE conformity marking and arrange conformity declaration. This attestation has been issued as per company required. This attestation does not abrogate the compulsory obligation of the manufacturer to issue the declaration of conformity.

Integra96, yukarıda bahsi geçen firmanın ürüne ilişkin sunduğu dokümantasyonu yukarıda belirtilen referans yönetmelik ve / veya standartlara göre incelemiştir. Yönetmeliğe ve standartlara göre ürünün ve dokümantasyonun uygunluğu firma sorumluluğundadır. Ürünün diğer ilgili yönetmelik ve standartlara tabi olması durumunda diğer yönetmelik ve standartların şartlarını da firma yerine getirdiğinde yukarıda belirtilen CE uygunluk işareti ürün üzerine iliştilir ve uygunluk beyanı düzenleyebilir. Bu onay firmanın isteği üzerine verilmiştir. Bu onay üreticinin uygunluk beyanı düzenleme zorunluluğunu ortadan kaldırmaz.

Cengiz TAHRİR
İNTEGRA96 Belgelendirme
İZMİR, (rev. 00) <15.10.2021>

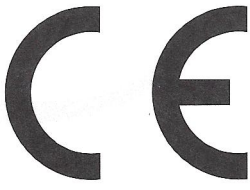

UYGUNLUK ONAYI ATTESTATION OF COMPLIANCE

Reference No:

TRC-21-1510/02

Referans Nu.:

Applicant:

Başvuru Sahibi:

Gemaş Genel Mühendislik Mekanik San. ve Tic. A.Ş

**İTOB Organize Sanayi Bölgesi 10001 Sokak No: 28 Tekeli Menderes
İzmir / Türkiye**

Manufacturer:

Üretici:

Gemaş Genel Mühendislik Mekanik San. ve Tic. A.Ş

**İTOB Organize Sanayi Bölgesi 10001 Sokak No: 28 Tekeli Menderes
İzmir / Türkiye**

Product:

Ürün:

STREAMER TRIPHASE POOL PUMP

STREAMER TRİFAZE HAVUZ POMPASI

Type/Model:

Tip/Model

**STRN-80T, STRN-100T, STRN-150T, STRN-200T, STRN-300T,
STRN-350T, STRM-80T, STRM-100T, STRM-150T**

**Market Of Electrical Equipment Designed For Use Within Certain Voltage Limits
Directive**

Reference Directive(s):

Referans Yönetmelik(ler)

**2014/30/EU On The Harmonisation Of The Laws Of The Member States Relating To
Electromagnetic Compatibility**

Makina Emniyeti Yönetmeliği (2006/42/AT)

**Belirli Gerilim Sınırları İçin Tasarlanan Elektrikli Ekipman ile İlgili Yönetmelik
(2014/35/AB)**

Elektromanyetik Uyumluluk Yönetmeliği (2014/30/AB)

**TS EN 60204-1:2018, EN 60335-1:2012 + A11:2014 /AC:2014+A13:2017 +A14:2019
+A2:2019 +A1:2019, EN 60335-2-41:2003 + A1:2004 + A2:2010, TS EN ISO
12100:2010, EN 809:1998 +A1:2009/AC:2010, EN 61000-6-3:2007/A1:2011/AC:2012,
EN 62233:2008**

Reference Standard(s):

Referans Standart(lar)

File of technical documentation, test reports

Base of attestation:

Onay Dayanağı:

**Ref. No. ECP.18.03.R0015, ECP.18.03.R0017, 18-1284-R00-N02-02, 20180115-002
Teknik Dokümantasyon, ECP.18.03.R0015, ECP.18.03.R0017, 18-1284-R00-N02-02,
20180115-001 numaralı test raporları**

Issue Date:

Yayın Tarihi

15.10.2021

Expiry Date:

Geçerlilik Tarihi

14.10.2022

Integra96, has inspected the documentation presented concerning the product of the company whose name and address mentioned above according to the reference directive and/or reference standards. Suitability of product and documentation to the directive and standards are under the responsibility of the company. However, in case the product is subject to more than directives and standards which are mentioned above, when the company fulfills conditions of other directives and standards, then it can attach CE conformity marking and arrange conformity declaration. This attestation has been issued as per company required. This attestation does not abrogate the compulsory obligation of the manufacturer to issue the declaration of conformity.

Integra96, yukarıda bahsi geçen firmanın ürüne ilişkin sunduğu dokümantasyonu yukarıda belirtilen referans yönetmelik ve / veya standartlara göre incelemiştir. Yönetmeliğe ve standartlara göre ürünün ve dokümantasyonun uygunluğu firma sorumluluğundadır.

Ürünün diğer ilgili yönetmelik ve standartlara tabi olması durumunda diğer yönetmelik ve standartların şartlarını da firma yerine getirdiğinde yukarıda belirtilen CE uygunluk işareti ürün üzerine iliştilerilebilir ve uygunluk beyanı düzenleyebilir. Bu onay firmanın isteği üzerine verilmiştir. Bu onay üreticinin uygunluk beyanı düzenleme zorunluluğunu ortadan kaldırmaz.

**Cengiz TAHER
İNTEGRA96 Belgelendirme
İZMİR, (rev. 00) <15.10.2021>**

2850 rpm

Self-priming Pumps

GEMAS "STREAMER MICRO"

Self-priming, thermoplastic body Monoblock Pool Pump; complete with pre-filter. Suction & Discharge 1 1/2". Connections are with unions. 2850 rpm - IP 55 Motor.



Description	Code	Pieces/box	Weight Kg	Volume m ³
•STR-250MIC 1/3 HP, Monophase	0111STRMIC30	1	11,880	0,051
•STR-370MIC 1/2 HP, Monophase	0111STRMIC40	1	12,850	0,051

PUMP TYPE	HP	CONDENSER (μF)	AMPERES II 220 V	HEAD mwh							
				6	7	8	9	10	13	14	
				FLOW m ³ /h							
STR-250MIC	0,33	-	1,20	5,70	5,10	4,30	3,50	1,50	-	-	
STR-370MIC	0,50	-	2,20	7,50	7,00	6,50	5,90	5,20	2,10	-	



With union connection

GEMAS "PUMPEX-JET"

Counter current pump. Suction 2", Discharge 1 1/2". Connections are with unions. Pump shaft in stainless steel. IP55 motor.

Description	Code	Pieces/box	Weight Kg	Volume m ³
•PUMPEXJ-50M 0,50 HP, Monophase	0111PXJ50M	1	16,000	0,066
•PUMPEXJ-75M 0,75 HP, Monophase	0111PXJ75M	1	17,000	0,066
•PUMPEXJ-75T 0,75 HP, Triphase	0111PXJ75T	1	16,000	0,066
•PUMPEXJ-100M 1 HP, Monophase	0111PXJ100M	1	17,000	0,066
•PUMPEXJ-100T 1 HP, Triphase	0111PXJ100T	1	16,000	0,066
•PUMPEXJ-150M 1,5 HP, Monophase	0111PXJ150M	1	17,000	0,066
•PUMPEXJ-150T 1,5 HP, Triphase	0111PXJ150T	1	18,000	0,066
•PUMPEXJ-200M 2 HP, Monophase	0111PXJ200M	1	22,000	0,066
•PUMPEXJ-200T 2 HP, Triphase	0111PXJ200T	1	21,000	0,066
•PUMPEXJ-300M 3 HP, Monophase	0111PXJ300M	1	22,000	0,066
•PUMPEXJ-300T 3 HP, Triphase	0111PXJ300T	1	21,000	0,066

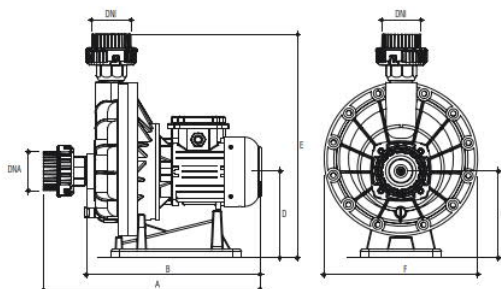
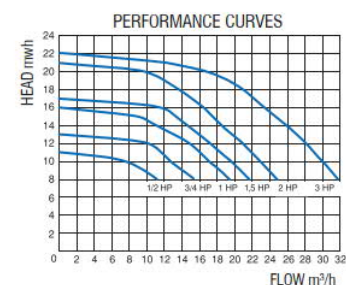

Cross section of impeller system.

PUMP TYPE	HP	CONDENSER (μF)	AMPERES			HEAD mwh							
			II 220 V	III 220 V	380 V	8	10	12	14	15	16	18	20
			FLOW m ³ /h										
PXJ-50M	0,50	13	2,60	-	-	11,14	7,25	-	-	-	-	-	-
PXJ-75T/M	0,75	20	3,80	3,70	-	15,33	12,64	10,00	-	-	-	-	-
PXJ-100T/M	1	25	4,95	3,11	1,80	19,43	17,00	14,84	11,00	8,89	-	-	-
PXJ-150T/M	1,5	30	7,80	4,41	2,55	21,65	19,47	17,12	14,57	13,30	11,36	-	-
PXJ-200T/M	2	40	9,90	5,88	3,40	24,80	22,90	20,90	18,40	17,50	16,40	13,60	9,60
PX-300T/M	3	40	-	8,00	4,90	32,00	30,00	28,00	26,00	25,00	23,50	21,00	17,00

PUMP TYPE	DIMENSIONS								Net Weight (Kg)		Gross Weight (Kg)	
	DNA	DNI	A	B	C	D	E	F	Mo.	Tri.	Mo.	Tri.
PXJ-50M	2"	2"	470	375	185	185	460	315	16,500	-	18,120	-
PXJ-75T/M	2"	2"	470	375	185	185	460	315	17,420	-	20,320	19,120
PXJ-100T/M	2"	2"	470	375	185	185	460	315	18,620	17,420	20,320	19,120
PXJ-150T/M	2"	2"	490	395	185	185	460	315	18,520	19,420	20,120	21,120
PXJ-200T/M	2"	2"	490	395	185	185	460	315	23,420	21,420	25,120	23,120
PXJ-300T/M	2"	2"	490	395	185	185	460	315	24,120	24,420	26,120	26,120

TYPE	Packing Dimensions (mm)
PXJ - 50 / 75 / 100 / 150 / 200 / 300	560 x 360 x 400

PUMPEX JET PUMP

GEMAŞ Pumpex-Jet thermoplastic body countercurrent pump. Ideal for usage with jet nozzles, counter current systems, fountains or similar water attractions.



2850 rpm – IP55 motor

Pump shaft in AISI 316 quality stainless steel

Suction 2'', Return 1 1/2'' connection

Connections are with unions

Body made of fiber glass reinforced PP

Impeller made of Noryl

Plastic cap EU made high resistant bearing

Monophase models with thermal switch

Product Information:

PERFORMANCE CURVES

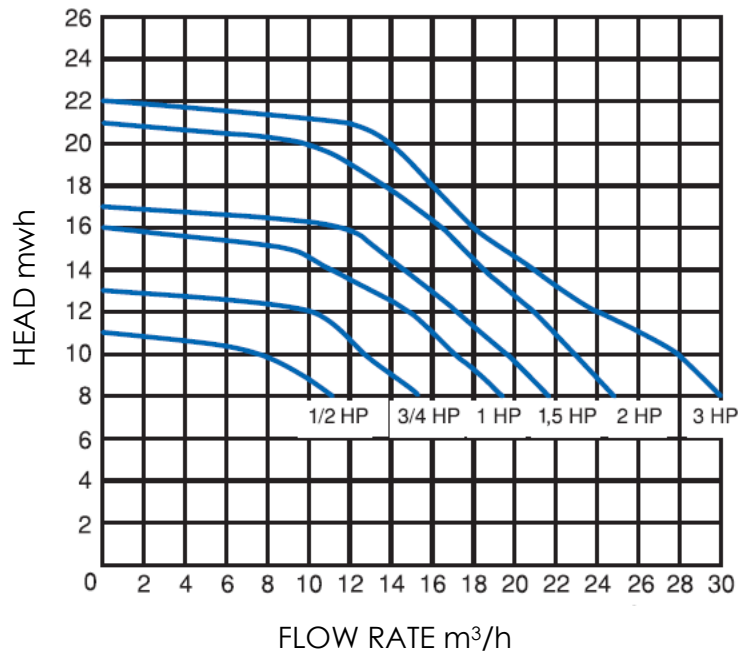

PUMP TYPE	HP	CONDENSER (μF)	AMPERES			HEAD mwh							
			II			8	10	12	14	15	16	18	20
			220V	220V	380V	DISCHARGE m³/h							
0111PXJ50M	0,50	13	2,60			11,14	7,25	–	–	–	–	–	–
0111PXJ75M/T	0,75	20	3,80	3,70	–	15,33	12,64	10,00	–	–	–	–	–
0111PXJ100M/T	1	25	4,95	3,11	1,80	19,43	17,00	14,84	11,00	8,89	–	–	–
0111PXJ150M/T	1,5	30	7,80	4,41	2,55	21,65	19,47	17,12	14,57	13,30	11,36	–	–
0111PXJ200M/T	2	40	9,90	5,88	3,40	24,80	22,90	20,90	18,40	17,50	16,40	13,60	9,60
0111PXJ300M/T	3	40	–	8,00	4,90	32,00	30,00	28,00	26,00	25,00	23,50	21,00	17,00

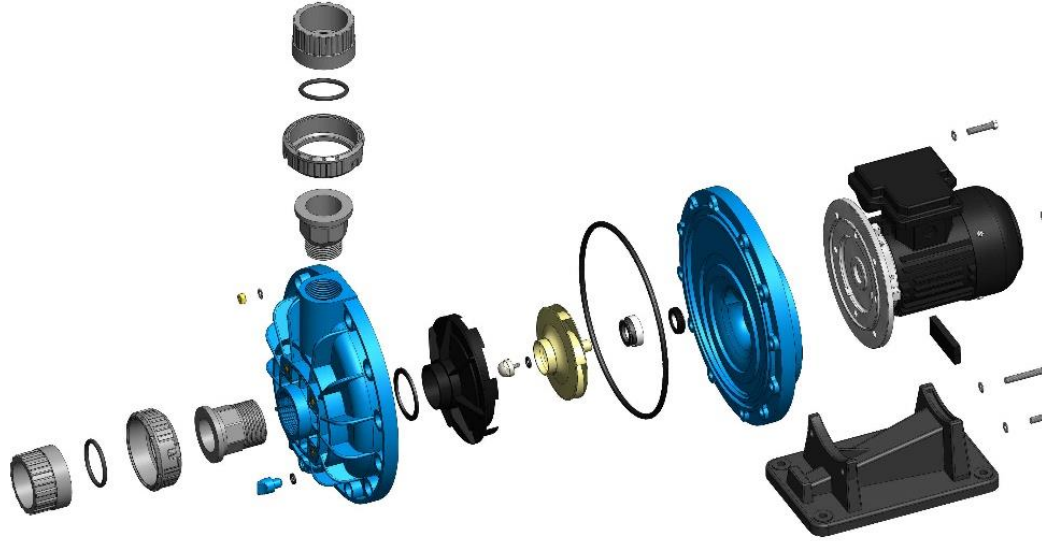

CODE	DESCRIPTION
0111PX10	PUMPEX - FRONT PUMP BODY
0111PX12	PUMPEX - BODY O-RING 264X250X7
0111PX13	PUMPEX - DIFFUSER GASKET 70X6
0111PX14	PUMPEX - DIFFUSER
0111PX1604	PUMPEX IMPEILER 2 HP
0111PX17	PUMPEX - MECHANICAL SEAL COMPLETE
0111PX18	PUMPEX - REAR BODY PUMP
0111PX24	IMBUS SCREW M10X20
0111PX25	PUMPEX - PUMP LEG
0111PX26	PUMPEX RUBBER FOOT PUMP SUPPORT FOR
0111STR02	DRAIN PLUG
0111STR03	O-RING FOR DRAIN PLUG
0111STR37N	COUNTER SCREW İNOX
2132003	İNOX WASHER M5
13111512	Ø 50 PVC BALL VALVE NUT
13211601	Ø 63MM UNION BODY
13212201	Ø 63 PVC UNION GEAR PART 2"
132123R01	Ø 63-50 PVC REDUCTION WITH A UNION GEAR PART
8500399	M8X70 İNOX SCREW
850041	M8x30 Grass Nut
860281	Ø 63MM PVC UNION O-RING 53,34X5.34
2132010	İNOX SCREW M8X30

Dimensions:

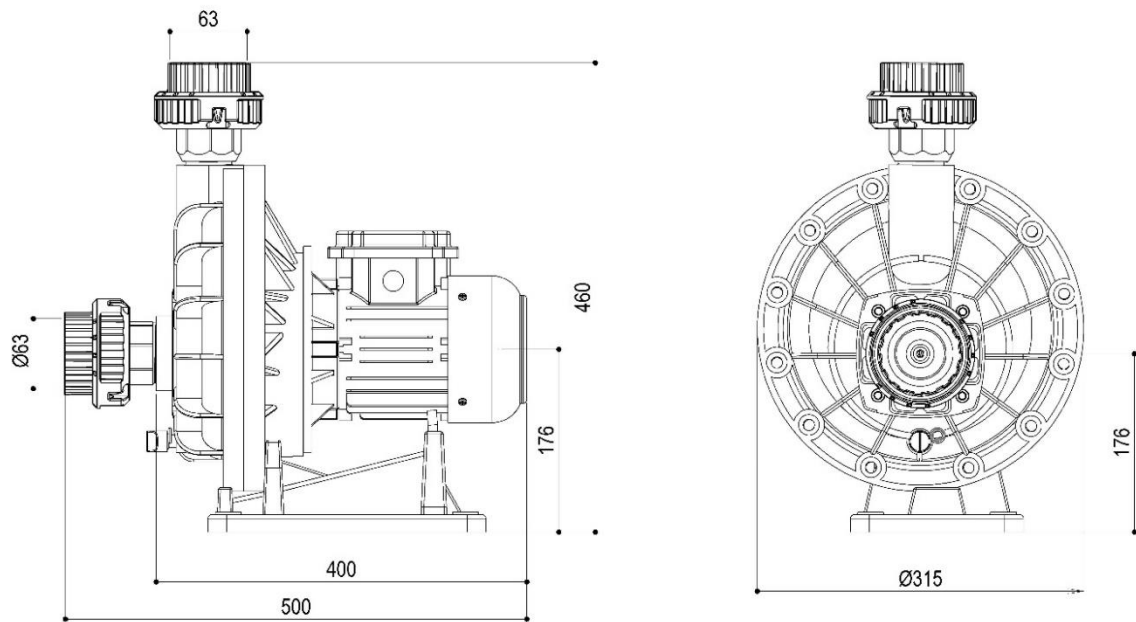

All dimensions are in mm.



"Pool Technology"